



COPD Medications

Long acting

Combination Medications

Advair®

- 100/50 250/50 500/50



AM 1 Puff PM 1 Puff

- 45/21 115/21 230/21



AM 2 Puffs PM 2 Puffs

Symbicort®

- 80/4.5 160/4.5



AM 2 Puffs
PM 2 Puffs

Other

Serevent®



Spiriva®



AM 1 Puff

Steroid Inhalers

Flovent®

- 44 mcg 110 mcg 220 mcg 50 mcg



AM 1 2 Puff (s)
PM 1 2 Puff (s)

Asmanex®



AM 1 2 Puff (s)
PM 1 2 Puff (s)

Pulmicort®

- 90 mcg 180 mcg



AM 1 2 Puff (s)
PM 1 2 Puff (s)

Short acting

2 puffs every _____ hours as needed



ProAir® Proventil® Ventolin® Xopenex®

Atrovent®



2 Puffs 2 Puffs
 2 Puffs 2 Puffs

Combivent®



2 Puffs 2 Puffs
 2 Puffs 2 Puffs

Contact your provider if you have questions about the information provided.

The registered trademark holders of the above images are not associated with or sponsors of San Francisco Health Plan.



How to Use Your Diskus



1 Hold it like this



2 Put your thumb here



3 Push thumb this way to open



4 Here is the mouth piece to open



5 Put your thumb here



6 Push back to click open



7 Window is open, medicine is inside. **Do NOT shake.**



8 Breathe **OUT** and away from the diskus

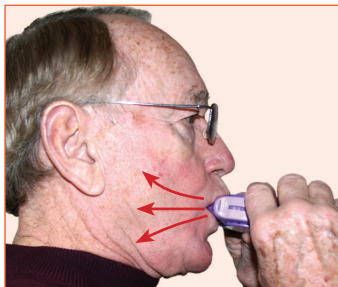

9 Close lips around the mouthpiece. **Breathe IN fast and deep.**



10 Hold your breath for 10 seconds if you can



11 Close the diskus



12 Rinse with water and spit out

Contact your provider if you have questions about the information provided.

The registered trademark holders of the above images are not associated with or sponsors of San Francisco Health Plan.



How to Use Your Dry Powder Inhaler (Asmanex®)

AM  1 2 Puff (s)

PM  1 2 Puff (s)



1 Twist bottom like this to remove cap



2 Here is the cap and the mouthpiece

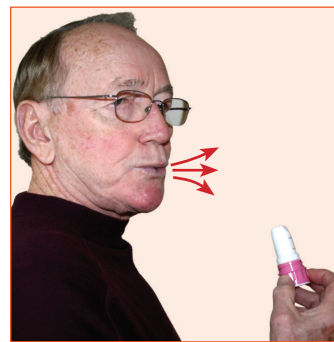

3 Breathe **OUT** and away from inhaler

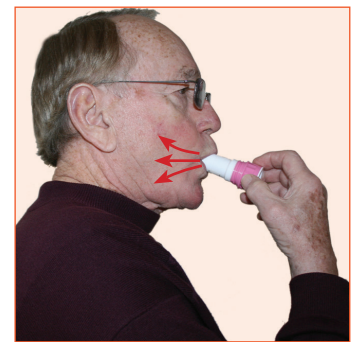

4 Put lips around mouthpiece. Breathe **IN** fast and deep.



5 Hold your breath for 10 seconds if you can

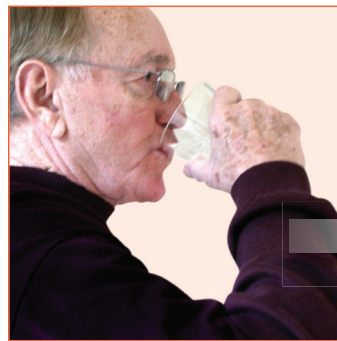

6 Rinse with water and spit out

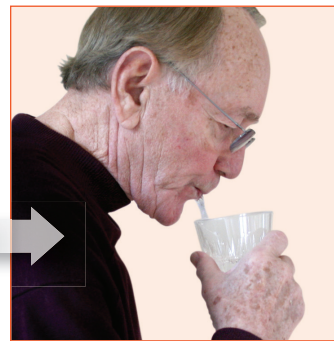

7 Put cover on and twist to close

Contact your provider if you have questions about the information provided.

The registered trademark holders of the above images are not associated with or sponsors of San Francisco Health Plan.

9066 1115

©2012 Institute for Education on Health and Research

SAN FRANCISCO HEALTH PLAN 

Here for you



How to Use Your Dry Powder Inhaler (Pulmicort®)

AM  1 2 Puff (s)

PM  1 2 Puff (s)

90 mcg

180 mcg



1 Twist bottom like this to remove cap



2 Here is the cap and the mouthpiece



3 Hold the mouthpiece



4 Twist bottom this way



5 Then back this way to hear "click". Now the inhaler is ready to use

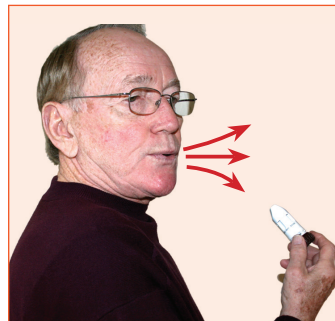

6 Breathe **OUT** and **AWAY** from inhaler

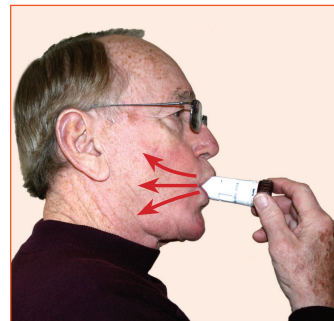

7 Put lips around mouthpiece. Breathe **IN** fast and deep.



8 Hold your breath for 10 seconds if you can

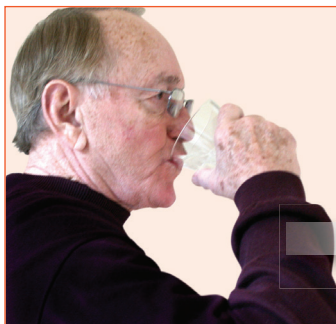

9 Rinse with water and spit **OUT**

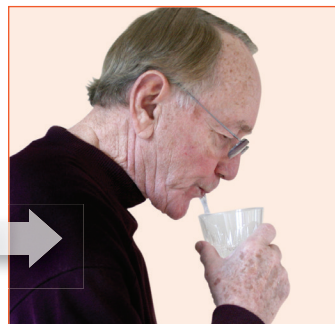

10 Put cover back on, twist to close

Contact your provider if you have questions about the information provided.

The registered trademark holders of the above images are not associated with or sponsors of San Francisco Health Plan.



How to Use A Spacer with Control Inhaler

AM  1 2 Puff (s)

PM  1 2 Puff (s)



1 Take the cap off the inhaler



2 Shake the inhaler



3 Attach to spacer



4 Take the cap off the spacer



5 Breathe OUT all the way



6 Close lips around mouthpiece



7 Press down here



8 Breathe IN slow and deep



9 Hold your breath for 10 seconds if you can.



10 Then breathe out slowly



11 If you need another puff of medicine, wait 1 minute then repeat steps 5-10



12 Rinse with water and spit OUT

Contact your provider if you have questions about the information provided.

The registered trademark holders of the above images are not associated with or sponsors of San Francisco Health Plan.



How to Use Your Spacer and Quick Relief Inhaler

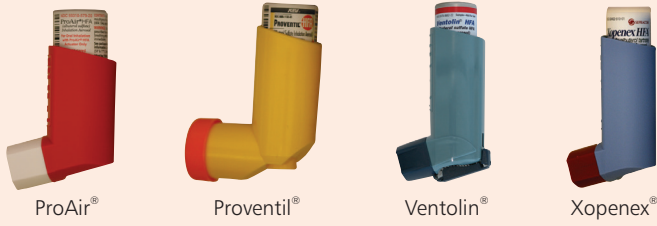

- 2 puffs before exercise
- 2 puffs every _____ hours as needed

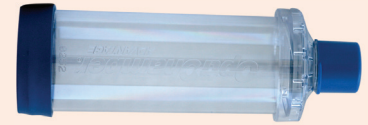

1 Take the cap off the inhaler

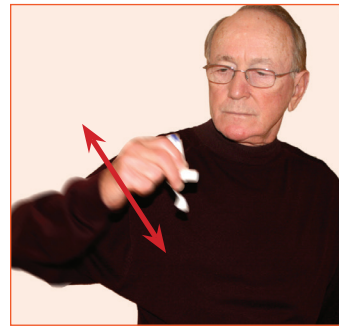

2 Shake the inhaler

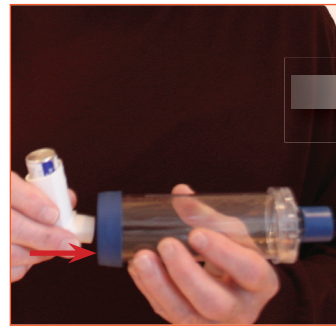

3 Attach to spacer

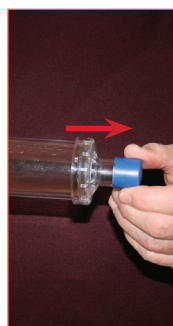

4 Take the cap off the spacer

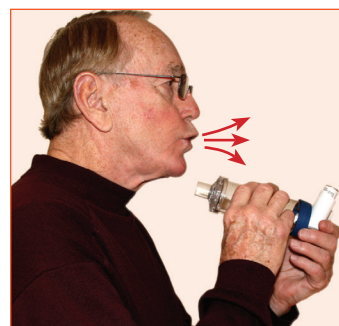
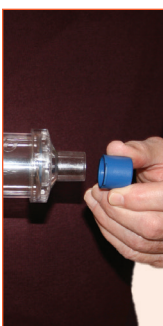

5 Breathe **OUT** all the way



6 Close lips around mouthpiece



7 Press down here



8 Breathe **IN** slow and deep



9 Hold your breath for 10 seconds if you can.

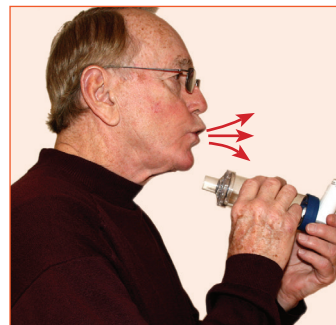

10 Then breathe out slowly



11 If you need another puff of medicine, wait 1 minute then repeat steps 5-10

Contact your provider if you have questions about the information provided.

The registered trademark holders of the above images are not associated with or sponsors of San Francisco Health Plan.



How to Use the Spiriva® HandiHaler®

STEP 1 Get Your HandiHaler® Ready to Use



A Press green button to open the cap



B Pull cap up



C This is the mouthpiece

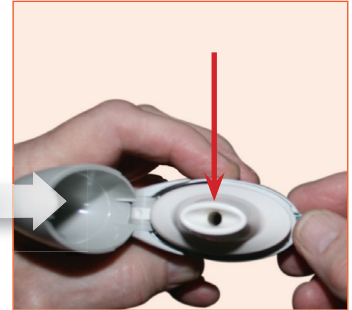

D Open the mouthpiece

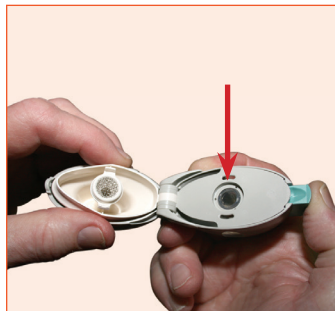

E Medicine goes in here

STEP 2 Get Your Spiriva® Medicine Ready to Use



A Open one Spiriva® medicine pack

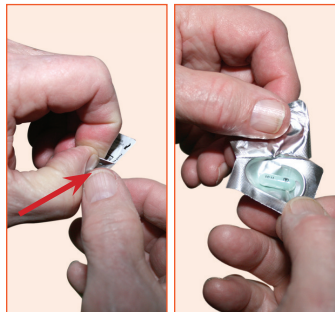

B Pull back here to open Spiriva®



C Take capsule out



D Do NOT put capsule in mouth

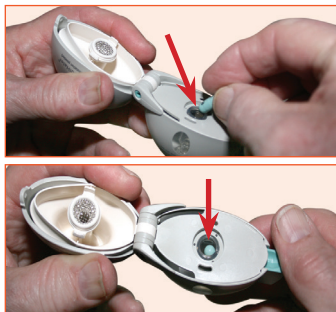

E Put capsule here



F Close mouthpiece tightly.



G You will hear a click



H Press the green button all the way in (only press once). This crushes the medicine inside

➤ see next page for STEP 3

How to Use the Spiriva® HandiHaler® continued from previous page

STEP 3 To Take Your Medication



A Put lips around mouthpiece



B Breathe in slow and deep

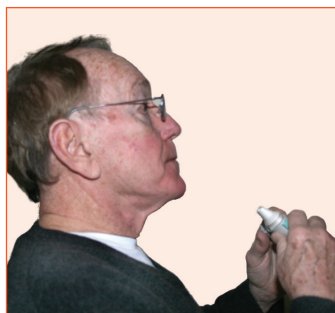

C Remove HandiHaler® and hold your breath as long as you can



D Breathe out and breathe normally



E Breathe in again slow and deep



F Remove HandiHaler® and hold your breath as long as you can



G Breathe out and breathe normally

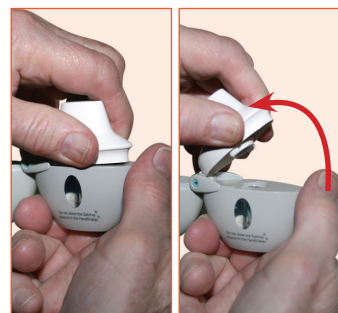

H Open the mouthpiece



I Remove used capsule

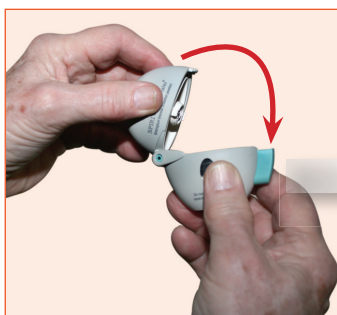

J Close your inhaler



Contact your provider if you have questions about the information provided.

The registered trademark holders of the above images are not associated with or sponsors of San Francisco Health Plan.

9066 1115

©2012 Institute for Education on Health and Research

**SAN FRANCISCO
HEALTH PLAN** 
Here for you